

eater.co.uk



for greater independence, dignity and choice



Neater Solutions for everyday needs

Neater Solutions is recognised by health professionals and clients worldwide for the design, manufacture and supply of specialist equipment designed to give people greater independence, dignity and choice in their lives. Thousands of people use our products; many have generously allowed us to use their pictures and quotations in this brochure and on our website.

This brochure contains information about our products. New products are being introduced all the time, so please check out our website and contact us to discuss your specific requirements or if you have an idea which you think we should consider developing. (Our contact details are on the back of this brochure)

If you have an unmet need, ask us for a Neater Solution.

A free DVD is also available.

Latest information including video can be found on our website:

www.neater.co.uk

*“After you set up the **Neater Eater** I very rapidly became proficient at feeding myself. I found the design to be excellent and very adaptable. We have already taken it with us when visiting friends; this is an enormous bonus. It has had a great effect on my self-confidence and on my quality of life.”*

*“I now have my **Neater Arm Supports** and they have totally transformed my life. I am able to eat independently and do other things that I was unable to do.”*



All our products are developed and Made in the UK.



Contents

page

Neater Arm Support

enables people with muscle weakness to use their arms

4



Neater Eater®

a modular system that enables people to feed themselves

6



Manually operated Neater Eaters

7



Electric Programmable Neater Eater

9

Neater Eater accessories:

10



Cutlery

Neater Button Switches



Crockery

Dignity Ware

11



Neater Table

accessible for wheelchair users



Neater Drinker

12

Neater Drinker Thermo

Neater Snacker



Neater Powered Drinker

suitable for drinks and pureed food

13

Neater Uni-Chair

unique efficient one-arm drive manual wheelchair

14

Some of the Neater Solutions team

15



Further info: www.neater.co.uk

Contact details on back cover



Neater Arm Support

Based on a prototype developed at the University of Cambridge, the powered **Neater Arm Support** enables people with muscle weakness to use their arms.

Described by many users, therapists and carers as: *“an essential piece of equipment for people with Duchenne muscular dystrophy or spinal muscular atrophy.”*

Functional benefits:

- Enables users to lift their arms to feed themselves, drink, use a phone, scratch their head, wipe their nose, brush their teeth, wash etc.
- Supports the user's arm when using a keyboard or laptop

Powered vertical movement



Angled forearm joint so elbow drops as arm raises bringing hand closer to face. Position adjustable to suit user.

Light-touch switch to control height.

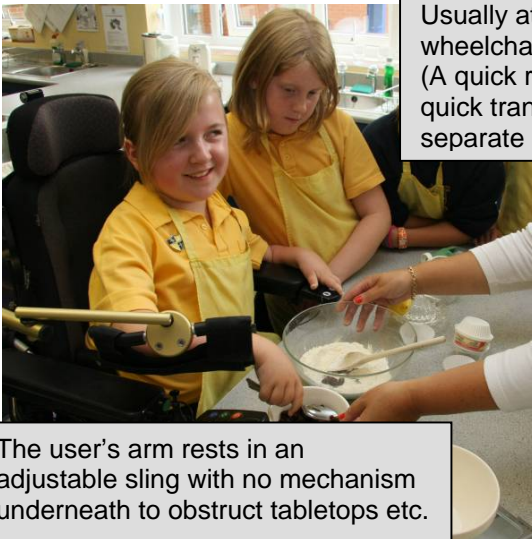

Usually attached to the back of the user's wheelchair using a system of brackets. (A quick release system is available for quick transfer between chairs or a separate stand.)

The user's arm rests in an adjustable sling with no mechanism underneath to obstruct tabletops etc.

Physical benefits

- Independent movement through large range reduces development of joint contractures
- Gentle assisted movement helps maintain strength
- Use of normal movement patterns helps reduce development of postural deformities

Psychological benefits

- Less dependence on carers for simple tasks such as feeding oneself, scratching or rubbing an eye is likely to be psychologically beneficial.
- Encourages social interaction through taking part
- Helps maintain dignity and self-respect
- Improves interest in vital food and activities

“Wow, I can use a mobile phone!”

Teenage user

“It's AWESOME!”

Teenage user

A twin arm bracket enables quick change from right to left handed use. (Particularly useful for exercising the user's other arm.)

"That's brilliant!"
User's mum

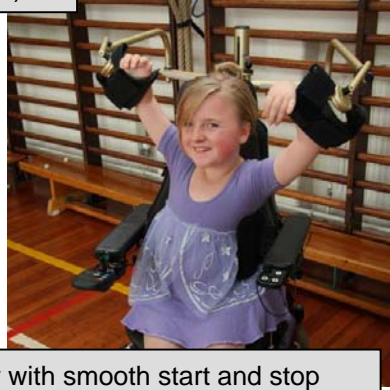

Variable speed motor with smooth start and stop and programmable end-stops. Power is usually taken from the wheelchair's batteries.

The four-link frictionless arm folds around the wheelchair allowing a wide range of movement without adding to the chair's width or significantly to its length.

Suitability + Free Home Assessments

- Whilst the Neater Arm Support is frictionless, it does not power-assist horizontal movement. Some users may have too much stiffness in their own arm muscles and joints or they may have contractures which limit significantly the range of movement.
- It is important that potential users start early in order to gain the physical benefits and help maintain their range of movement.
- For convenience, our free assessments are carried out with a unit on a separate stand. We take measurements for later fitting to the user's chair.

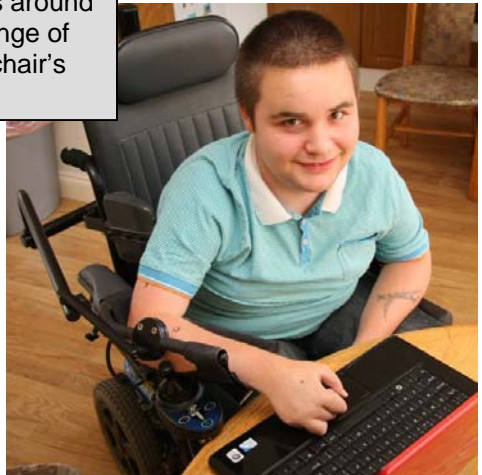

"The Neater Arm Support can be invaluable for people with a progressive weakness of the shoulder girdle muscles. It can help to reduce the development of joint contractures and maintain muscle strength". **National Occupational Therapy Advisor, Muscular Dystrophy Campaign**

"I can now do functions that I could not do before such as adjusting my glasses, scratching my chin, exercising my shoulder and eating as many crisps as I want!" **Student**

Neater Eater®

The **Neater Eater** is a modular system with components designed to enable people to use their own movements to feed themselves.

Free Home Assessments

– ensure equipment choice and set-up to best suit individual abilities and needs.

Current users include people with cerebral palsy, multiple sclerosis, motor neurone disease, head injuries, spinal injuries, rheumatoid arthritis, muscular dystrophies, upper limb amputations, cerebella ataxia, strokes, Parkinson's disease, learning difficulties and many other neurological conditions and disabilities.



The benefits:

- Increases independence
- Encourages social interaction through taking part in mealtimes
- Helps maintain dignity and self-respect
- Helps teach movements, improve posture and mouth control
- Improves interest in vital food
- Assists carers.



"The Neater Eater gives me independence and enables my wife and I to have our meals together again." **User**

Neater Eater® – basic example

- manually operated by the user moving the handle themselves
- internal mechanisms control movement, keep the spoon level and the plate steady

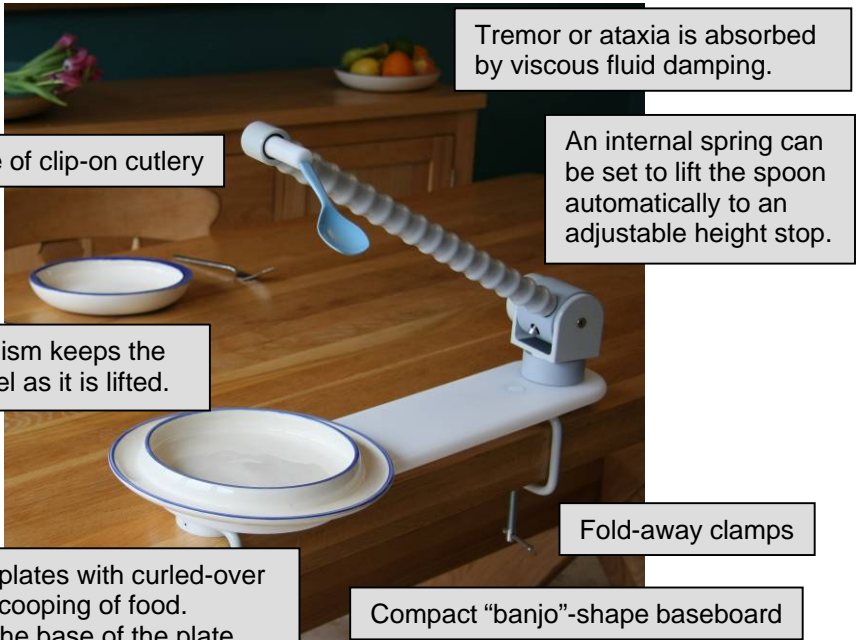

“The Neater Eater is an invaluable piece of equipment in maintaining someone’s independence and self esteem.”
Senior Occupational Therapist

“The Neater Eater has enabled me to be independent and not rely on somebody to eat. It’s been fantastic.”
User

Neater Eater® – example with additional attachments

- a modular system of attachments and adjustments are available to enable use by people with a wide range of abilities
- free home assessments are available to ensure the best set up

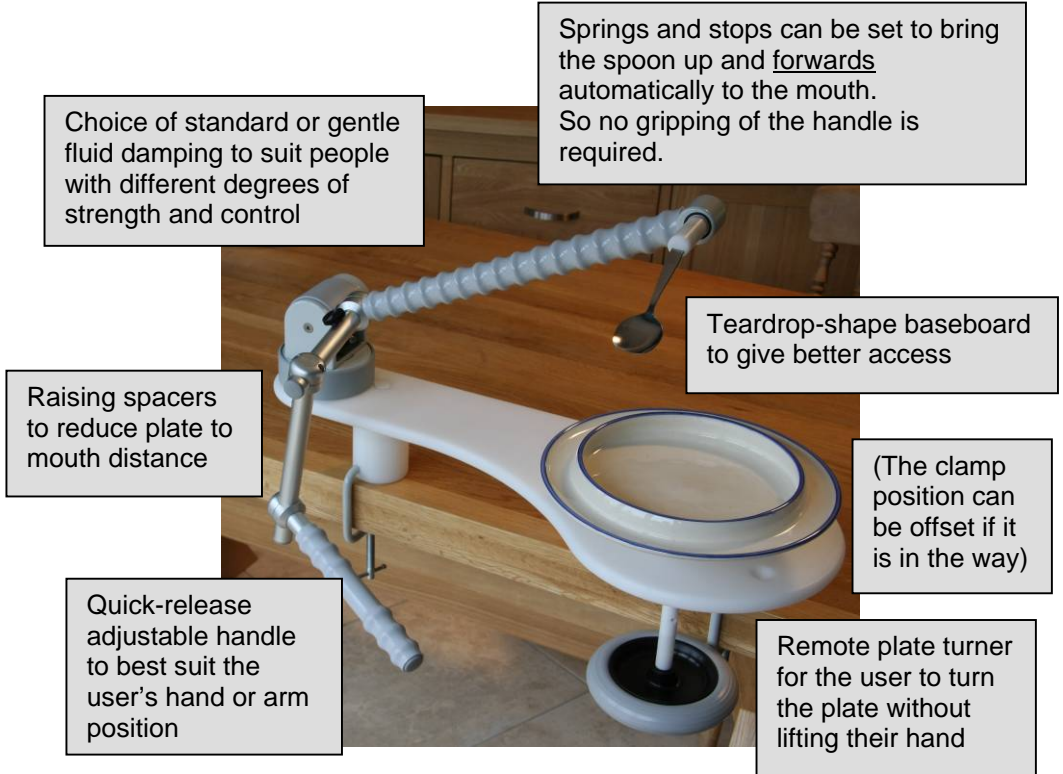

"I would like to see as many children as possible using Neater Eaters, because many families are still spoon-feeding their children, when the children could have their own independence." **User's dad**

Neater Eater® – electric programmable version

- switch operated with light (or heavy) movements of fingers, head or foot
- easily programmed for up to five users with different positions, pause times and operating choices.

PRODUCTS
MILLENNIUM
Design
Council
award for
Innovation

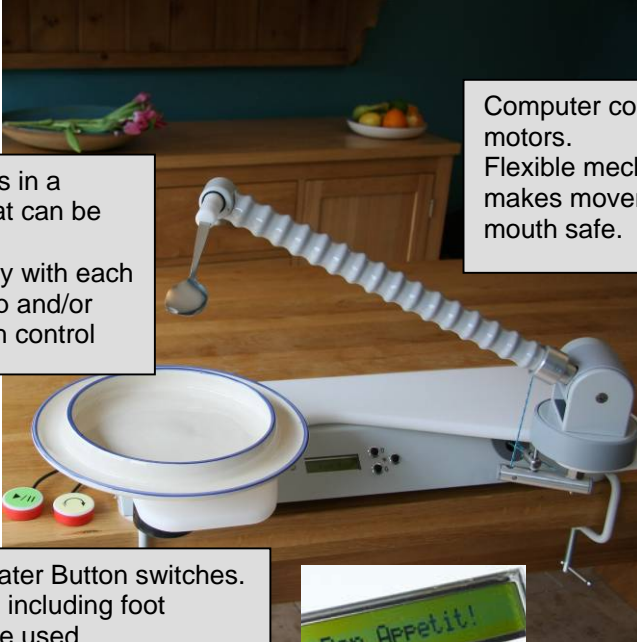

Computer controlled motors.
Flexible mechanism makes movement to mouth safe.

Plate locates in a turntable that can be set to turn automatically with each spoon scoop and/or under switch control

Light-touch Neater Button switches. Other switches including foot switches can be used. Most users simply use one switch to start or pause a spoon cycle (scooping food and bringing it to their mouth) and another to turn the plate to align food for scooping.



Head switches



Joypad for programming new mouth positions



*“Clearly the Neater Eater is an essential tool for independence. As a **speech and language therapist** it’s also particularly useful for encouraging good posture and lip closure.”*

Cutlery and attachments for Neater Eater

Neater Eaters are supplied with two items of cutlery in white clip-on holders

- Standard flattened front aids scooping.
- Round front spoons and soup spoon available for runny food.
- Narrow spoons and small spoons for children, people with head tremor and others.
- Blue polycarbonate spoons are quite rigid. Brown unbreakable spoons are softer and suitable for people with a strong bite.
- Stainless steel "sporks", forks and spoons only for people with good head control.
- Sandwich Holder



Neater Button Switches

- Very light touch (applied directly or at an angle) with a slight tactile feedback.
- Velcro mounting included
- 4.5cm x 1.7cm deep

See price list for details of other switches



Crockery for Neater Eater

Neater Eaters are supplied with a plate stand and two items of crockery with a peg underneath to locate in baseboard.

- Small ceramic 21cm x 3.3cm deep
- Large ceramic 26cm x 2.5cm deep.
- Dishwasher, microwave and ovenproof
- Curled over lip aids scooping
- Rim catches spills
- Blue edges aid visibility

Other options:

- **Heated Ceramic Plate** with cavity for microwave heated pad. 26cm x 2.5cm
- Soup Bowl with saucer attached. Requires Soup spoon for Neater Eater. 18cm x 5.3cm deep.
- Plastic plate with vertical lip. Size: 24cm x 2.3cm deep. Blue or Ivory.
- Plate Stand for supporting plates with pegs e.g. on tray or in microwave. Ceramic or plastic.



Our Crockery is also available for use without the Neater Eater (without the peg)

This includes:

- **Heated Ceramic Plate** with cavity for microwave heated pad. 26cm x 2.5cm
- See price list for latest details

Dignity Ware

Ceramic Dignity Ware with inward turning lip to aid one sided eating and to avoid spillage.

- Dishwasher and microwave safe
- Blue edges aid visibility
- Plate 23cm x 3cm deep
- Bowl 16cm x 3.5cm deep
- Mug 8cm high



Neater Table

Originally developed to offer a stable wheelchair accessible platform for the Neater Eater, the Neater Table is now available for general use.

- Sturdy
- Height Adjustable 69 to 93cm high (add 6cm with castors)
- Fold away
- Easy Access (especially for wheelchair users)
- Lockable Castors (optional extra)
- 92cm wide x 50cm deep



Finger screws hold the veneered wooden top to the metallic frame which folds away easily by swivelling the legs around.

The rear cross beam of the Neater Table frame sits on the floor (or on 6cm castors if fitted) allowing wheelchair footrests to move over the top unobstructed.



Neater Drinkers and Neater Snacker

Portable and easily adjusted, limited head movement only is required to drink and eat snacks when out or at home.

The **Neater Drinker** is a special long straw in a special sturdy ceramic mug with a lid. The tough straw can be bent and positioned so that it can be reached easily. A non-return valve at the bottom keeps the drink in the straw and so makes sucking easier. The mug is very stable with a non-slip base and a lid holds the straw in place as well as keeping drinks warm.

Colour: Dark Blue. Capacity: 385ml.

The **Neater Straws** are also available separately. Standard length: 60cm. Long: 120cm. Soft mouthpiece attachment and syringe for priming straw are included.

The **Neater Drinker Thermo** is a plastic insulated version of the Neater Drinker. Colours: bright.

The **Neater Snacker** consists of a long arm on the end of a fold-away clamp, which holds it to a table or other furniture. The arm can be bent to any position so that it can be reached easily. A sandwich holder that can be used for other snacks such as pizza and biscuits clips on the end. The Neater Snacker can hold the same cutlery and attachments as the Neater Eater.



Neater Powered Drinker

The **Neater Powered Drinker** enables people to drink liquids and pureed foods at their own pace.

It has been used successfully by people with cerebral palsy with poor lip closure and by people with motor neurone disease who have difficulty sucking liquid up a straw.

Peristaltic pump – no moving parts touch the liquid

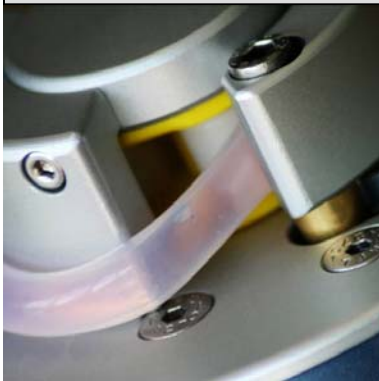

Choice of programmes ensures the amount of liquid in each cycle is right for the user.

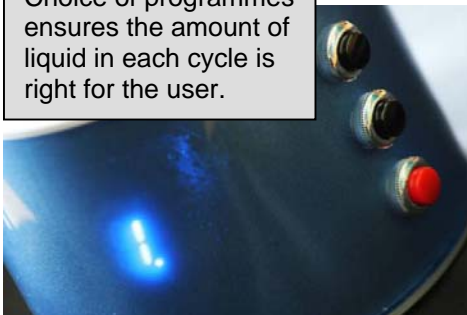

The Neater Powered Drinker may have benefits other than hydration and nutrition - such as reducing the need for drugs that help expel air from the stomach.

Any device such as this has the potential to cause choking. For this reason, it is only recommended for use by each individual after an assessment by a Speech and Language therapist.

Flexible tube suitable for liquid and thickened drinks and pureed food

Bendy arm straw holder

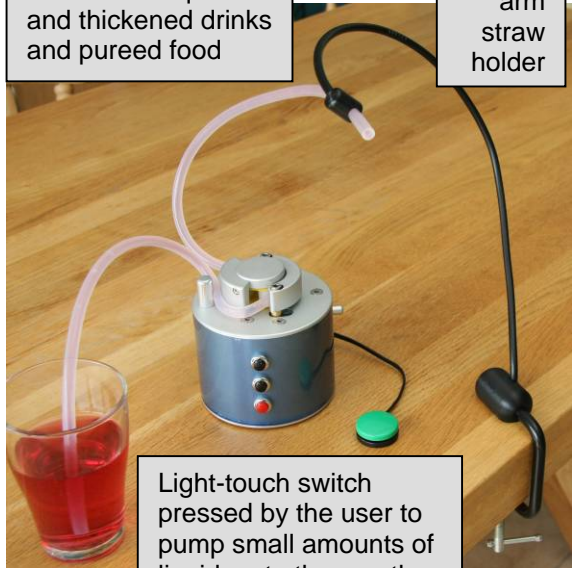

Light-touch switch pressed by the user to pump small amounts of liquid up to the mouth. Immediate repeat of the pumping cycle is prevented to give time for the user to swallow.



Neater Uni-Chair

The **Neater Uni-Chair** enables people with use of just one arm and one foot to operate a manual wheelchair efficiently. It is most commonly used by people with hemiplegia caused by stroke.



The user turns a single handrim to power both rear wheels through a unique differential mechanism; allowing the wheels to rotate at different speeds when cornering

Tight corners with one wheel stationary and three-point turns are easily achieved

Typically in trials, a user will complete a course in half the time than with alternative chairs – and with less uneven pressures on the user's body.

Developed in association with the University of Brighton, with a Health Technology Development Grant: *“The Committee was very impressed with your project and have agreed a score of 10 [out of 10]. Specifically, they were very impressed with your team's commitment to ensuring the optimum device was produced and how popular it has become with users in care homes, and how you have continued to make improvements based on their feedback.”*



Small turns of the user's foot are amplified through a cable linkage to steer the front wheel



“The single handrim is much less complicated than a dual handrim and the footplate mechanism moves easily. I can do three-point turns in confined spaces” User

Quick-release mechanisms for easy folding and dismantling - assists carers

Some of the Neater Solutions team



Jon Michaelis, Chartered Engineer and Managing Director, invented the first Neater Eater as a mechanical engineering student at Imperial College where he was awarded a first class honours degree and the Governors' prize in 1986. He started the company to make the technology available to people who need it. Working with potential users of the equipment, their therapists and carers, Jon and the dedicated team at Neater Solutions have continued to develop a range of products to help meet people's needs. "I feel privileged to be able to use my skills and those of others in this way. I am grateful to the many individuals that have offered help along the way."

Included amongst the organisations that have been involved are: National Hospital for Neurology, Imperial College, Action Research, Chailey Heritage, London Innovation, MS Society, Design Council, Business Link, Medilink, ERDF, NTI, Muscular Dystrophy Campaign, the Universities of Brighton, Nottingham and Cambridge, the Health Technology board and various NHS PCTs.

Ruth Mallard, Operations Manager, co-ordinates the day-to-day running of Neater Solutions and manages many of the projects. Hers will probably be the friendly and efficient voice that you hear when you call us.



John Foster, Neater Consultant, carries out equipment assessments in northern England and trains other assessors all over the world. He is also involved in equipment preparation, testing and development.

Check out our website: www.neater.co.uk See back cover for our contact details.

Neater Solutions

12 Burlington Road Buxton Derbyshire SK17 9AL United Kingdom

tel: ++ 44 (0)1298 23882 fax: ++ 44 (0)1298 23883

email: info@neater.co.uk

web: www.neater.co.uk

Brochure edition 4

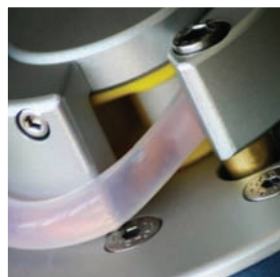
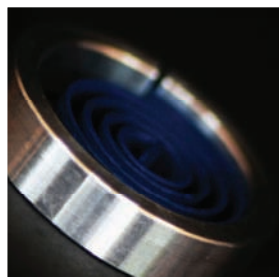
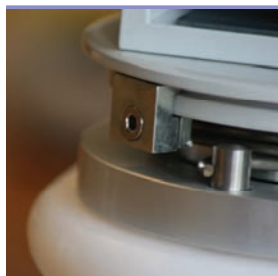
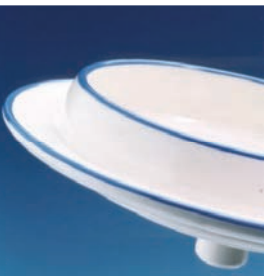

Your local contact:

Patents applied for